

The Courses & distances
from A. to B. up the river

N 20 W	17
N 44 N	40
N 20 N	54
N 5 E	16
N 40 E	23
N 54 E	18
N 70 E	32
S 89 E	39
S 85 E	40
S 70 E	14
S 50 E	35.5

To Stakes at B up the
River

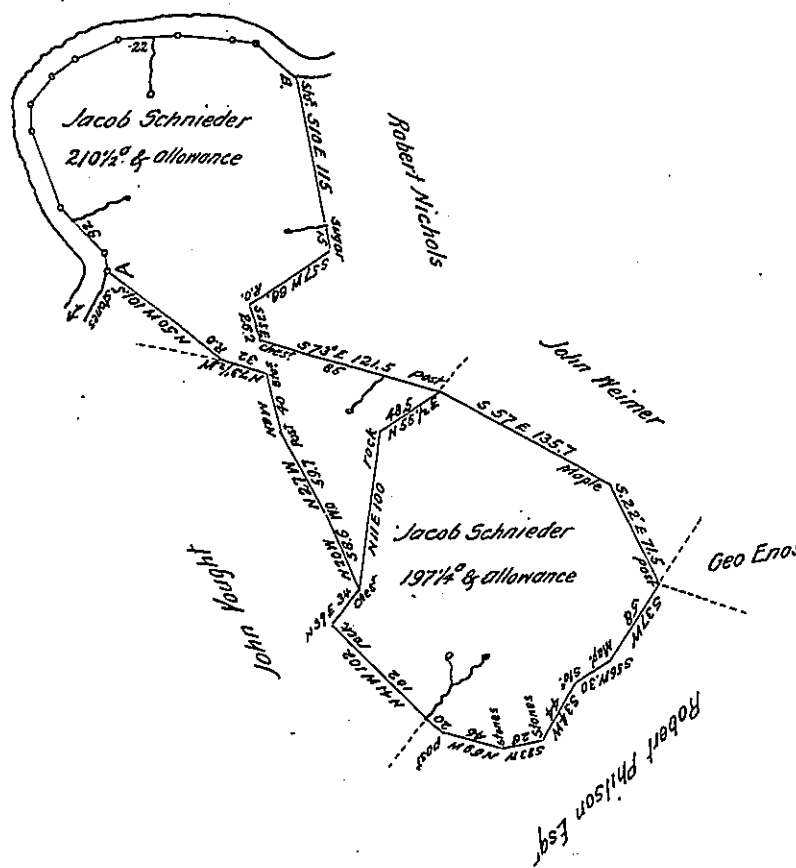

Situate adjoining the south side of Castleman's River in Turkeyfoot Township Somerset County and surveyed the 6th day of January 1812 in pursuance of two warrants granted unto Jacob Schnieder both respectively dated the 21st day of December 1811 which the said Schnieder requests granted him in one Patent the two surveys containing in all 407 1/4 a. allowance

To Andrew Porter Esquire }
Surveyor General }

Per John McLean Deputy

To wit Jacob Schnieder lives with his family on the 197 1/4 survey and has it largely improved the 210 1/4 part had a small improvement thereon when surveyed whereon there was grain raised and a small cabin thereon but not at that time resident

John McLean

Query Did ever Jacob Schneider claim and hold all the above described Land, by improvement made upon the two in 1786 upon the tract of 197 1/4 acres

IN TESTIMONY that the above is a copy of the original remaining on file in the Department of Internal Affairs of Pennsylvania, made conformably to an Act of Assembly approved the 16th day of February, 1883, I have hereunto set my Hand and caused the Seal of said Department to be affixed at Harrisburg, this
twelfth day of December 1906.

Lauchlin Curran
Secretary of Internal Affairs.